



PROJECT STUDY - CARPENTRY - WOODWORKING - FURNITURE



BODENMANN  
AGENCEMENT D'ESPACES







## OVER A CENTURY OF EXPERTISE

Since 1891, J. Bodenmann SA has established itself as an essential player in the field of custom-made interior design by integrating the values of know-how and rigor that have contributed to its reputation into its DNA. Each project is exceptional and deserves special attention to fit perfectly with its environment and requirements. We design and create exceptional living spaces using sustainable materials and advanced techniques to give your interiors a unique signature that reflects your personal vision. Thanks to a careful selection of high-quality materials and the expertise of our craftsmen, we are proud to offer you results of the highest quality, designed to accompany you for many years.





## OUR SERVICES

Our range of services covers four distinct professions. Through each of these domains, at every stage of your project, our team of specialists ensures continuous monitoring and a realization of superior quality.

### 01. PROJECT STUDY

A good project is a well-thought-out project. Involved from the first sketches and backed by a wealth of expertise, our technical office translates, interprets, and enhances your ideas, providing continuous support to ensure that your project unfolds as expected and meets the anticipated level of quality. Thanks to the creation of computer-generated imagery in 3D renderings, you will be able to visualize yourself in the redefined space before its realization.

### 02. CARPENTRY

Our carpentry creates custom solutions tailored to the needs of your project, combining excellent craftsmanship, modern technologies, and high-quality materials to offer a functional and aesthetic luxury experience, whether for residential or commercial projects.

### 03. WOODWORKING

Our workshop designs with a precision worthy of the greatest goldsmiths. From cutting to machining to assembly, our craftsmen perfectly master all the manufacturing steps to offer you incomparable quality, whether for a library, a desk, a bar, a dressing room, a reception piece of furniture, or any other custom creation.

### 04. FURNITURE

As an integral part of our offer, we provide a rich range of furniture and decorative elements for the furnishing of offices, hotels, professional and private spaces. This range of furniture is the result of a partnership with renowned manufacturers and can be customized to the image of your company.







## OUR PRODUCTS

Regardless of its nature, we bring to each project a keen sense of detail and a high level of quality. We work with a wide variety of species and materials.

## CUSTOM CREATIONS

Whether as a unique piece, in a limited series, or in larger quantities, our artisan carpenters create your custom projects: doors and windows, partitions, shutters, wall protections, stairs, handrails, terraces, bookcases, desks, wardrobes, dressings, or even showcases. The only limit is your imagination.

## WATCHMAKER AND JEWELER BENCHES

A historical activity of the company, the development and manufacture of furniture and equipment for the watchmaking industry has earned us a reputation for excellence. Beyond the high quality of execution, our products emphasize ergonomics, thus offering better comfort of use coupled with productivity gains.

## INDOOR AND OUTDOOR FURNITURE

Resulting from a partnership with renowned manufacturers, we offer a rich range of furniture products that include furniture and decorative elements designed for the arrangement of offices, hotels, professional, and private spaces.

## RESONANCE RANGE

Backed by the Risoud forest, world-renowned for its resonance spruce, we create in this high-quality wood with unique properties, supports for watches and music boxes. Capable of revealing the most subtle vibrations and sounds, the resonance spruce from Risoud is used in luthiery, watchmaking, and even the making of acoustic speakers.

## WALL PROTECTION

Meeting regulatory antibacterial hygiene standards, our wall covering systems are particularly suited for the hospital and agri-food sectors, to equip operating rooms, cheese cellars, shops, kitchens, or other arrangements.



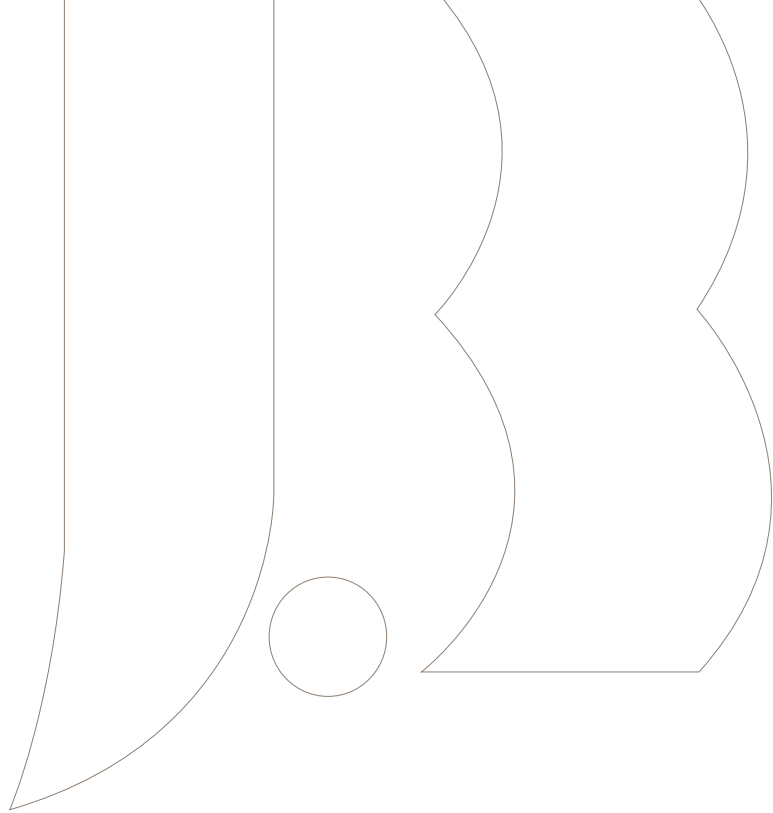

## OUR ACHIEVEMENTS

Our creations combine functionality, elegance, and design. Each piece is developed, step by step, in collaboration with the client and our teams of specialists to offer the most suitable solution. We invite you to discover a selection of the projects we have been able to realize.

8



Grand Théâtre de Genève





## Hôtel des Horlogers

Vallée de Joux

*In close collaboration with a renowned architectural firm, Bodenmann has been selected to breathe life and character into the interior of this prestigious establishment, aiming for a perfect harmony between function and aesthetics. Our role was to give life and personality to the spaces, while strictly adhering to the architect's directives: from unique headboards, desks with a sleek design, to wardrobes adorned with decorative glass. This is complemented by distinctive buffets, elegant claustras, and bathroom doors of unparalleled finesse. These meticulous finishes enrich the ambiance of the space, adding a touch of sophistication that blends seamlessly with the overall interior design. Each of these pieces reflects our passion for marrying the unique essence of the hotel with its functional imperatives.*





Situated in the heart of the City of Light, Geneva, with a breathtaking view of the majestic Rhône, the Mandarin Oriental hotel undertook a metamorphosis of its rooms and suites. Bodenmann, committed to shaping exceptional interiors, was chosen to realize this vision by providing its expertise in custom furniture. The creation of 3D renderings allowed the client to project themselves into the redefined space before its realization. This innovative tool not only streamlined the decision-making process but also ensured that every detail met the aspirations of the Mandarin Oriental Geneva.

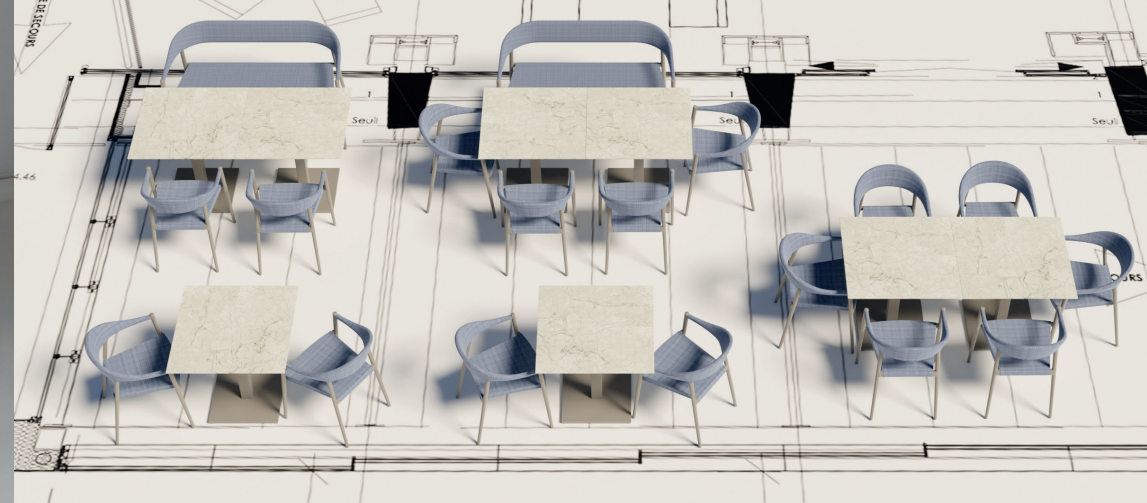



Private Villa, L'Abbaye

*Nestled in the heart of the Vallée de Joux, on the edge of the lake, stands an exceptional villa, a true masterpiece of craftsmanship and design. This residence is the result of a close collaboration with Bodenmann, bearing witness to our unparalleled expertise in cabinetmaking and woodworking. Every element of this villa, whether it be the delicately crafted doors, the woodwork rich in character, the custom kitchen, or the meticulously thought-out storage spaces, carries the imprint of our exceptional artisans. It is an ode to the art of precision, where each piece reflects our passion and commitment to excellence.*







Comité  
International  
Olympique

*Located in the heart of Lausanne, the monumental staircase of the Olympic House, inspired by the five Olympic rings, stands as the true backbone of the building. More than just a staircase, it offers a meeting space bathed in light under a majestic glass roof. Crafted in oak, its geometry reflects the dynamism of athletes. For five months, our teams worked to bring to life this masterpiece admired by all. This work results from a meticulous adaptation of the plans conceived by the architectural firm 3XN.*





## Maison de l'écriture, Montricher VD

*From the entrance, the library's access door stands as an invitation to a literary journey. Every corner has been designed to invite discovery. The library reflects our passion for detail while the large table, an oak slab supported by stone legs, is the beating heart of this place. For meetings, our rotating, foldable, and movable conference table symbolizes the alliance of aesthetics and functionality. The office space and exhibition room, with their oak paneling, represent our vision of this sanctuary dedicated to writing. Each element, from sliding doors to shelves, has been conceived to enrich the visitor's experience. Our imprint inside aims to make this place a haven for all lovers of words.*





# Company restaurant

Each of the 280 seats in the restaurant is enveloped by the essence of our work. The custom booths, in oak-imitation melamine and leather, transcend mere seating to offer multifunctionality and aesthetics with integrated sockets and flower troughs. The tables, meticulously crafted, oscillate between complete creations and harmonious replacements of tops. The standing tables with built-in sockets marry style and function and finally, the chairs, resulting from a trusted partnership, and the chosen fabric testify to our quest for quality. Every detail reflects our expertise and our pursuit of excellence.





The Bodenmann commitment

*At Bodenmann, we transform your ideas into tangible realities, whether they come from individuals or businesses. Our expertise ranges from the design office to perfect finishing, ensuring that every detail meets your expectations. Thanks to our dedicated team of artisans, we shape each project to reflect your vision. No matter the complexity or originality of your request, Bodenmann is here to realize it with precision and dedication.*









## SUSTAINABILITY

Every decision we make as a company has consequences and impacts our environment. Therefore, whether in our operations or in the development and design of our products, we strive to move towards a sustainable society and reduce our carbon footprint. And we take concrete action:

- We are 100% autonomous in terms of heating
- Photovoltaic panels supply 50% of our electricity consumption
- 100% of our waste is sorted and recycled thanks to our internal waste facility
- We guarantee traceability for 100% of the products we purchase
- We exclusively collaborate with certified partners
- We favor processed products and short supply chains
- We use resources responsibly and technically adapted for their use, while aiming for a zero-carbon objective
- We train our employees to ensure an awareness

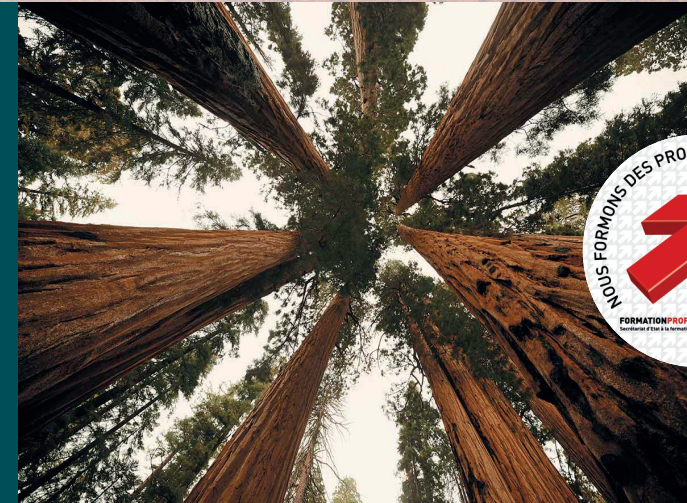







BODENMANN  
AGENCEMENT D'ESPACES

[www.bodenmann.ch](http://www.bodenmann.ch)